



# Haverford Township

1014 Darby Road  
Havertown, PA 19083  
Phone: (610) 446-1000  
www.haverfordtownship.com

## PLUMBING PERMIT APPLICATION

Fee \$ \_\_\_\_\_ Date \_\_\_\_\_ 20 \_\_\_\_\_

*Payment, insurance and a copy of signed contract must accompany the application.*

The following specification of Plumbing and Drainage, with description and accompanying plan, are submitted for review & approval:

Commercial  Residential

Location \_\_\_\_\_

Owner \_\_\_\_\_ Address \_\_\_\_\_

Applicant Name \_\_\_\_\_ Address \_\_\_\_\_

Applicant Email \_\_\_\_\_ Phone \_\_\_\_\_

Plumber \_\_\_\_\_ Address \_\_\_\_\_

Email \_\_\_\_\_ Phone \_\_\_\_\_

Register No \_\_\_\_\_

New Work  # of DFU's \_\_\_\_\_ Replacement  Estimated Cost \$ \_\_\_\_\_

Scope of Work \_\_\_\_\_

\_\_\_\_\_

\_\_\_\_\_

Water service  Sewer Lateral  Water Heater  Check Valve  Backwater Valve

All Plumbing Installations Require Rough and Final Township Inspections.

**This document shall verify that the above-referenced individual(s) is/are the Property Owners of the Property indicated within the Project Information Section and have identified the Contractor to serve as their duly authorized Agent for the submission of this Permit.**

Homeowner signature \_\_\_\_\_

Master Plumber signature \_\_\_\_\_

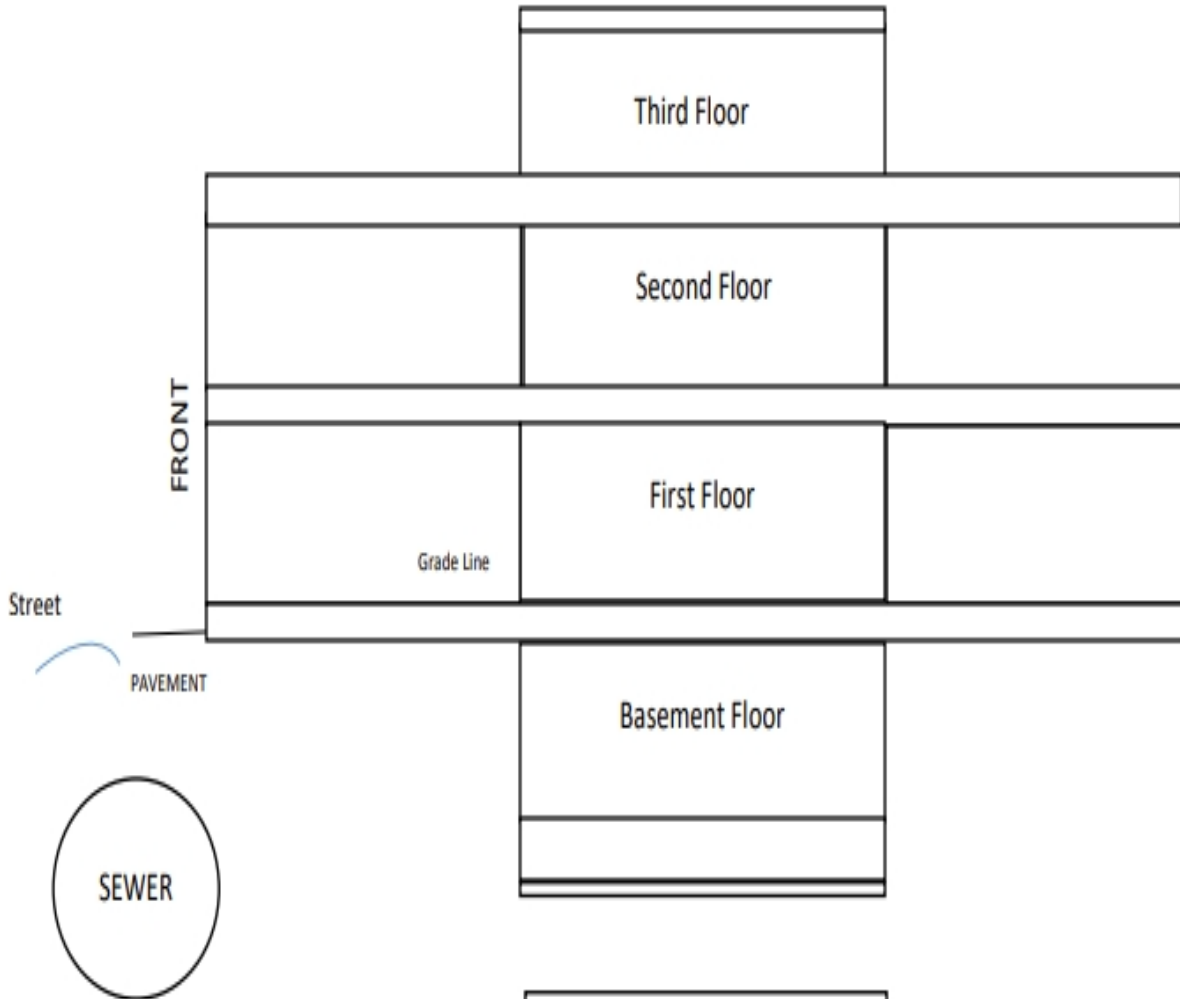

CELLAR PLAN



NEW WORK TO BE  
SHOWN IN RED;  
OLD WORK TO BE  
SHOWN IN BLACK